

CON ROD DESIGN DATA FORM

Con rods for _____ [engine make]

Load conditions

Type of engine		[2/4-stroke]
Number of cylinders		
Cylinder diameter / Bore		[mm]
Stroke		[mm]
Combustion pressure (extreme)		[bar]
Complete Piston weight (incl pin)		[g]
Max Rpm		[rpm]
Max torque		[Nm]
Max Temperature		[°C]

RPM spectrum

1 000		[% / cycles / sec]
2 000		[% / cycles / sec]
3 000		[% / cycles / sec]
4 000		[% / cycles / sec]
5 000		[% / cycles / sec]
6 000		[% / cycles / sec]
7 000		[% / cycles / sec]
8 000		[% / cycles / sec]
9 000		[% / cycles / sec]
10 000		[% / cycles / sec]
11 000		[% / cycles / sec]
12 000		[% / cycles / sec]
13 000		[% / cycles / sec]
14 000		[% / cycles / sec]
15 000		[% / cycles / sec]
16 000		[% / cycles / sec]
17 000		[% / cycles / sec]
18 000		[% / cycles / sec]

Geometry

Con rod length (C-C) (a)		[mm]
Diameter piston pin + tolerance (b)		[mm]
Max small end outer diameter (c)		[mm]
Max small end width (d)		[mm]
Diameter crank pin + tolerance (e)		[mm]
Max big end outer diameter (f)		[mm]
Max big end width: (g)		[mm]

One piece 2-piece Removable bearing shells

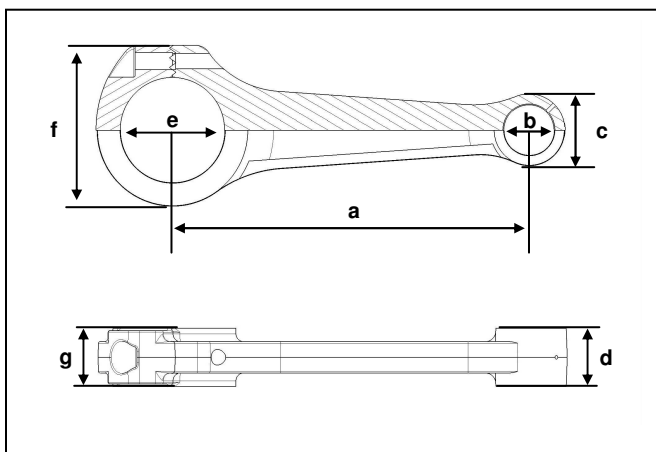

Special instructions